

VIEWPORT INSTALLATION INSTRUCTIONS

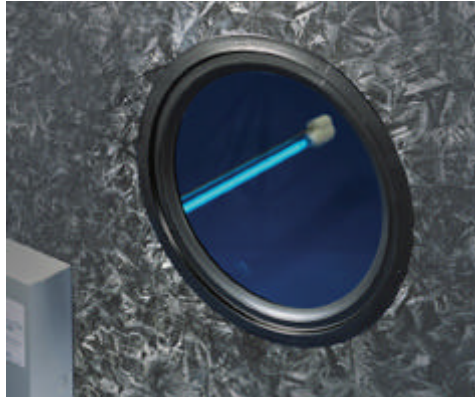

BEFORE BEGINNING THE INSTALLATION OF THE VIEWPORT, IT WILL BE NECESSARY TO DETERMINE THE MOUNTING LOCATION. THE MOUNTING LOCATION SHOULD BE DETERMINED FROM THE INSIDE OF THE AHU SO AS TO AVOID SUPPORTS. THERE SHOULD BE SUFFICIENT ROOM BETWEEN SUPPORTS TO PLACE THE VIEWPORT (13.25" DIAMETER). USE A PUNCH FROM THE INSIDE TO DIMPLE THE OUTER SHEET METAL WHERE THE CENTER OF THE VIEWPORT WILL BE PLACED.

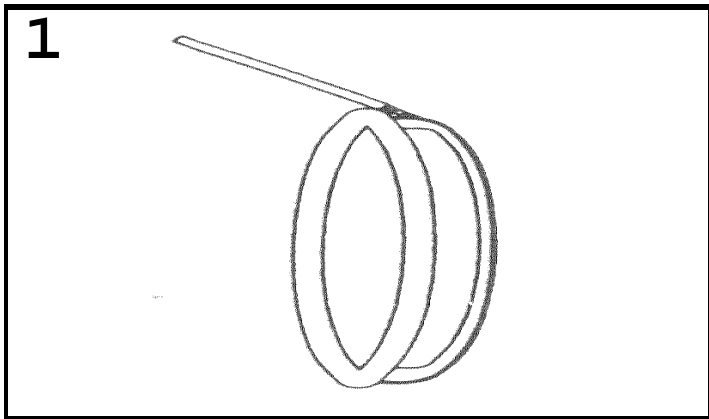

1 USE A MARKING PEN TO DRAW A CIRCLE 12" IN DIAMETER TO MARK THE CUTTING LINE. THE INNER SECTION OF THE FRAME MAY BE USED TO DRAW THE CUT LINE AS WELL. DRILL A STARTING HOLE INSIDE THE CIRCLE LARGE ENOUGH FOR YOUR CUTTING TOOL TO START IT CUT

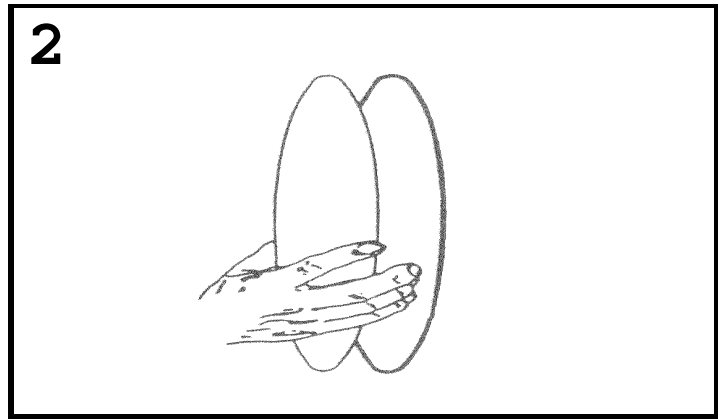

2 CUT OUT THE SHEET METAL ALONG THE MARKED LINE AND REMOVE. THE WINDOW IS NOW READY FOR INSTALLATION.

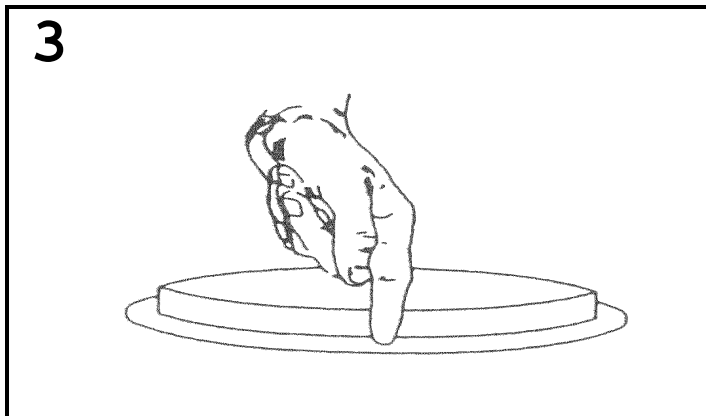

3 TO SEAL THE VIEWPORT, USE A SEALANT THAT IS SUITABLE FOR HVAC USE (SILICONE, BUTYL). APPLY THE SEALANT TO THE REAR SIDE OF THE VIEWPORT FLANGE AND PLACE INTO THE HOLE.

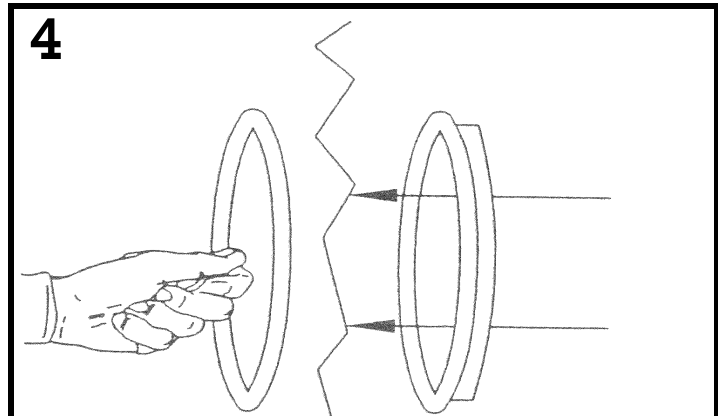

4 AN ASSISTANT MAY BE NECESSARY TO HOLD THE WINDOW CENTERED WHILE MOUNTING THE INNER TRIM RING OF THE FRAME WITH THE SCREWS PROVIDED. TIGHTEN ALL SCREWS UNTIL THE INNER RING IS SEALED.

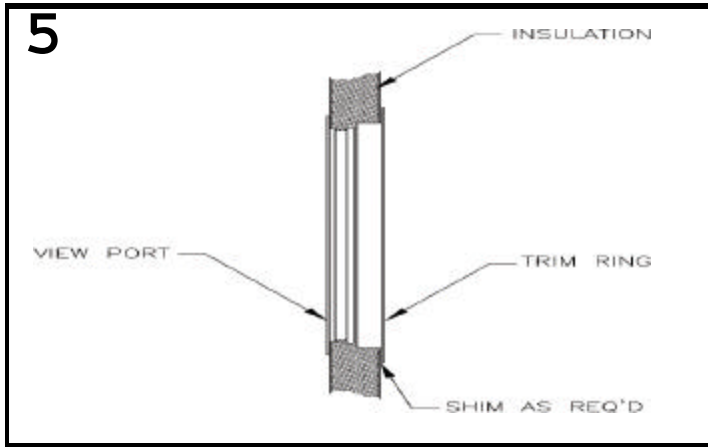

IF THE DUCT WALL IS INSULATED THE TRIM RING MAY BE REVERSED TO ACCOMMODATE THE INSULATION

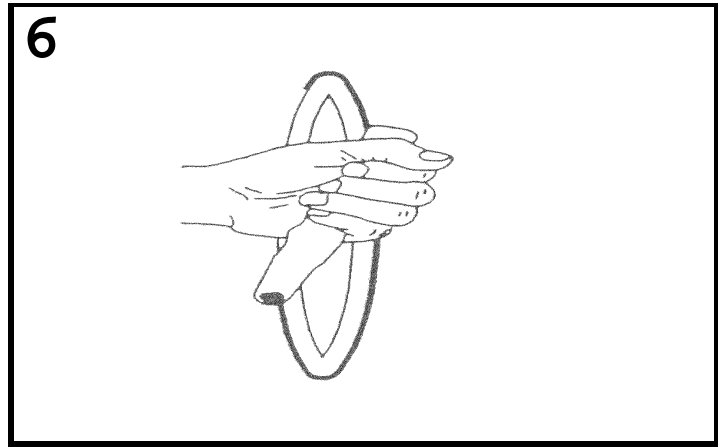

TRIM AWAY EXCESS SEALANT

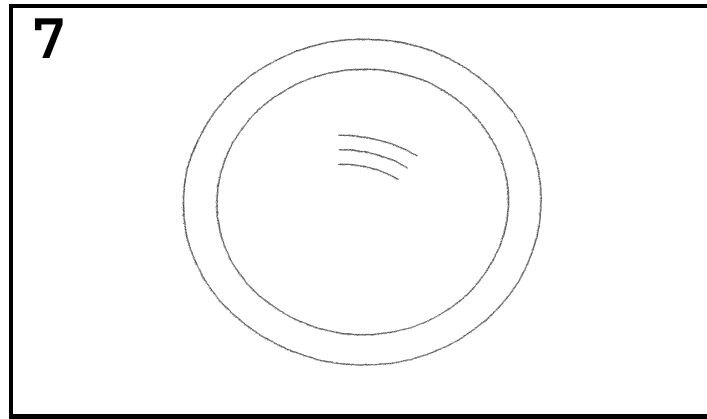

MAKE A FINAL INSPECTION OF THE PORTHOLE TO VERIFY CLAMPING AND FIT.

Model No.	Description	Weight	Part Number
GVP	Glass View Port Assembly	3 Lbs.	17-4013

ALTRU...V
 REAL SCIENCE FOR HVAC MAINTENANCE

26145 Technology Dr. Valencia California 91355

Phone 877.PUREUVC Fax 661.257.4698 sales@altruv.com www.altruv.com